



Ashland School District  
*inspiring learning for life*



DECEMBER 2022

# BOND NEWSLETTER

## GENERAL PROGRAM UPDATE

In the month of November, the highlight was the completion of TRAILS Outdoor School, as students and staff were able to start using the newly renovated school. Ashland Middle School work was comprised of punchlist items that are being wrapped up. At Walker Elementary, there was a heavy focus on getting the exterior building envelope and gymnasium roof completed in preparation for the coming winter weather. At the Maintenance and Transportation facilities, the HVAC upgrades are nearing completion and most of the new units were started up.



TRAILS OUTDOOR SCHOOL RIBBON CUTTING  
CEREMONY IN NEW COMMUNITY ROOM

## ASHLAND MIDDLE SCHOOL + TRAILS



## CURRENT ACTIVITIES

- **Building A, Gym/Locker Rooms** –The gym, locker rooms, wrestling room and staff offices are fully operable allowing indoor physical education classes and school sporting events to take place. This could not have come at a better time as winter weather is upon us thus limiting outdoor activities.

- **Ashland Middle School** – Fire safety related updates continue to progress in this otherwise fully operational campus. Final commissioning and user training continue to progress for various systems in the new facility as part of the project completion process.

KEY PLAN

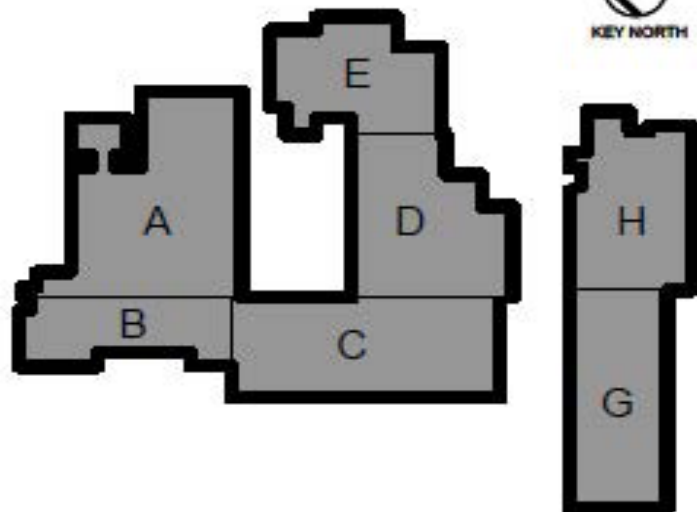

- **Building G/H, TRAILS** – Staff and students are thriving on their new campus as of November 7th. The official ribbon cutting ceremony took place in the community room on November 17th and acted as a perfect representation of the vision for this space. Punchlist items are nearly 100% resolved which is the final step in completion of the building.

- **Site Work** – Only landscape punchlist items and finalization of the irrigation work remain with protection of hydroseed in place allowing grass areas to establish for next spring.

## ACTIVITIES SCHEDULED FOR NEXT PERIOD

- Final punchlist items for both schools including landscape
- Fire safety related updates scheduled for Winter break due to building access





CAMPUS  
LANDSCAPE  
ESTABLISHING







TRAILS FIRST DAY OF SCHOOL



## HIGHLIGHTS

- TRAILS staff and students are at home in their new learning environments
- Vegetation is establishing well providing life to the campus landscape
- AMS middle gym is operational serving the school and community for events



## HELMAN ELEMENTARY SCHOOL



## CURRENT ACTIVITIES

The construction of this building has a net reduction in the school's energy use that truly models the Ashland School District's adoption of the City of Ashland's Climate and Energy Action Plan (CEAP). The new classroom building also includes a SPED instructional space with exterior play area, sensory room with state-of-the-art furnishings, a large multipurpose room with an operable exterior wall and multiple breakout spaces scattered throughout the building.

The front administration area underwent a full renovation that included an access-controlled entry. New reception area, conference room and staff work room concluded the new spaces included in the administration area.

Campus wide, a new 4-Pipe hydronic HVAC system that includes new high efficiency boilers, new air handlers and a new chiller was installed. A new building controls system, allowing the district to operate the new systems as efficiently as possible and minimize any maintenance or troubleshooting delays, was also included. The campus also received a new fire alarm system bringing everything up to current building codes.

On the exterior of the site, a new entry drive was installed that will aid with traffic congestion during high traffic periods. Additional parking was installed at the south end of the campus. There is a brand new 1/8th mile walking track and new playground that is accessible to all. New landscaping wraps up the remainder of the campus.





### ACTIVITIES SCHEDULED FOR NEXT PERIOD

- Continued Commissioning.









## ASHLAND HIGH SCHOOL - ADA COMMONS UPGRADE



### CURRENT ACTIVITIES

The ADA Commons project achieved substantial completion September 1st, 2022. Stair remediation has been scheduled for the summer months of 2023, with the same builder (Adroit Construction Company). We have received the schedule and quote for stair replacement.



### ACTIVITIES SCHEDULED FOR NEXT PERIOD

- The installation of the plaza benches.



## CURRENT ACTIVITIES

Windows have been installed with weatherproofing and testing is in progress. Mechanical, electrical, and low voltage are continuing to progress throughout the facility. Drywall, texture and paint are pushing along to allow for casework and finish in several areas. Areas of polished concrete floors is expanding, and epoxy floors are actively being installed.

The walk-in coolers and kitchen ventilation hood are installed shaping the food storage and preparation areas. Structural steel is rapidly progressing in the courtyard utility service area, at the covered canopies and with the gym seismic retrofit. Stucco is being applied at the renovated building portion of the project.

## WALKER ELEMENTARY SCHOOL



## ACTIVITIES SCHEDULED FOR NEXT PERIOD

- Irrigation and landscape
- Completion of window sheetmetal and system testing
- Installation of grid ceiling and hardlid
- Stucco application
- Conclusion of sheetrock, finish and painting
- Completion of the gym building roofs



WINDOW  
TESTING







STRUCTURAL STEEL AT  
COURTYARD COVERED WALKWAYS

## HIGHLIGHTS

- Window installation and testing
- Structural steel activities
- Paint in several areas of the building
- Stucco at the renovated building

## CHALLENGES

- Cold and/or wet weather
- Labor shortage
- Material lead times



COPPER  
PIPING  
IN THE  
BOILER  
ROOM



POLISHED CONCRETE FLOORS



RESTROOM TILE WORK



The following list of local vendors who are currently working on the projects.

#### ASHLAND AREA VENDORS AND CONTRACTORS (DEFINED AS ROGUE VALLEY)

- Arkitek:design&architecture
- Adroit Construction Co.
- Ciota Engineering
- DOBRIN
- Covey Pardee Landscape Architecture
- Infinity Electric
- Douglas Engineering Pacific
- Van Row Mechanical
- HMK Company
- Cascade Communications
- KenCairn Landscape Architecture
- Quality Fence
- Bean Electric
- Pacific 3D Reality Capture
- Renfro
- Pariani Land Surveying
- Britannia
- Powell Engineering
- Patriot Landscaping
- ZCS Engineering & Architecture
- Sandeen Masonry
- Beflor
- Alco
- Top Notch
- Quality Fence
- S&S Sheetmetal
- Metal Masters
- Urban Racks
- Moore Construction
- Curtis Huntley
- Devry
- Cut N' Break
- Precision Electric
- Advanced Air
- Welburn Electric
- Hall of Fame Moving
- New Horizons Woodworks

